

|             |                        |                            |                     |                       |   |  |   |  |   |
|-------------|------------------------|----------------------------|---------------------|-----------------------|---|--|---|--|---|
|             | 5                      |                            | 4                   |                       | 3 |  | 2 |  | 1 |
| PART NUMBER | ITEM ①<br>BODY         | ITEM ②<br>CONTACT          | ITEM ③<br>INSULATOR | ITEM ④<br>CUPLING NUT |   |  |   |  |   |
| 26-8016     | BRASS<br>NICKEL PLATED | BERYLLIUM<br>NICKEL PLATED | TPX                 | ZINC<br>NICKEL PLATED |   |  |   |  |   |

DRAWING NO.  
**26-8016**

| REVISIONS |   |
|-----------|---|
| A         | RELEASE FOR QUOTATION   |
|           | 04-28-06 L Y U T  |
| B         | CHANGE THE OVERALL LENGTH TOLERANCE:<br>ADD THREAD CHAMFER DIM. 1X45°<br>ADD 3&4 NOTES. |
|           | 12-20-06 L Y U T  |

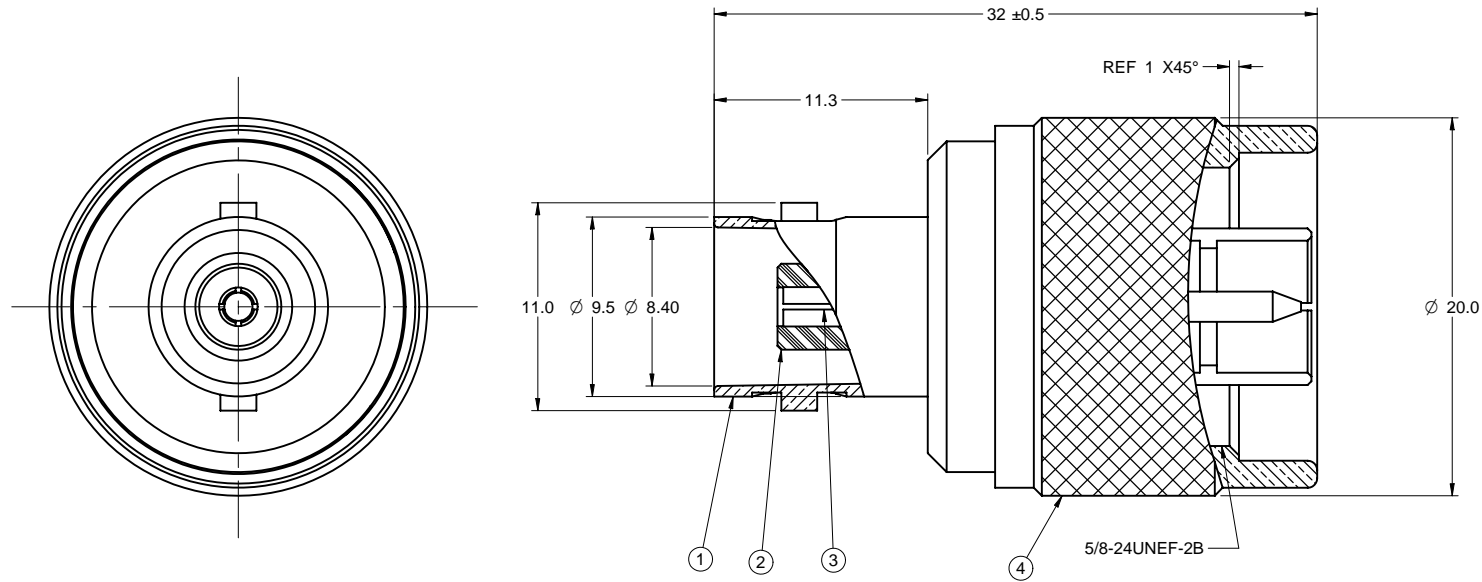

NOTES:

- MECHANICAL SPECIFICATIONS  
MATING INTERFACE: BNC 50 OHM  
CABLE ACCEPTABILITY: N/A  
CABLE HEX CRIMP SIZE: N/A
- ELECTRICAL SPECIFICATIONS:  
  
IMPEDANCE: 50 OHMS NOMINAL  
DIELECTRIC WITHSTANDING VOLTAGE : 500 VRMS FOR ONE MINUTE  
WORKING VOLTAGE : 500 WV RMS  
FREQUENCY RANGE : 0-4GHZ
- PRODUCT SHOULD BE RoHS COMPLIANCE.
- PACKAGING REQUIREMENT FOLLOWS ENGINEERING DOCUMENT P/N 836-40200001XX

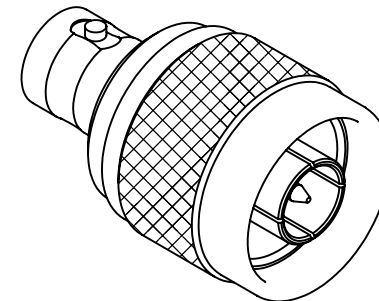

THIS DRAWING TO BE INTERPRETED  
PER ANSI Y 14.5M - 1994

**COMPANY CONFIDENTIAL**

|                                      |        |                        |                  |
|--------------------------------------|--------|------------------------|------------------|
| TOLERANCE UNLESS OTHERWISE SPECIFIED |        | DRAWN BY<br>LINDA.WU   | DATE<br>12-20-06 |
| DECIMALS                             | mm     | CHECKED BY<br>BETTY.YU | DATE<br>12-20-06 |
| X                                    | + 0.5  | APPROVED BY<br>THOMAS  | DATE<br>12-20-06 |
| X.X                                  | + 0.2  |                        |                  |
| X.XX                                 | + 0.05 |                        |                  |
| ANGLES                               | + 0.5° | U/M                    | mm               |

**EMERSON**  
Network Power

**Connectivity Solutions**

TITLE  
**N PLUG TO BNC JACK**

|  |  |                 |                               |                  |
|--|--|-----------------|-------------------------------|------------------|
| THIS DRAWING WAS PRODUCED BY COMPUTER.<br>DO NOT SCALE DRAWING OR UPDATE MANUALLY. |  | SHEET<br>1 OF 1 | DRAWING NO.<br><b>26-8016</b> | SIZE<br><b>C</b> |
|--|--|-----------------|-------------------------------|------------------|

D  
C  
B  
A

D  
C  
B  
A